



SUZUKI MARINE

Parts Book

DT 2 (1977-1979)



1703 Hwy 35 So., Laurence Harbor, NJ 08879

(732) 264-7176

(800) 338-0645 FAX (732) 264-2472

www.brownspoint.com

PREFACE

This parts catalogue has been arranged to include all prior modification as the final edition.

No revised edition will be issued any more and be sure to make use of this in good keeping.

Upon receipt of this final edition, the old catalogue should be thrown away.

This parts catalogue covers the list of all service parts for SUZUKI DT2~DT9 (C, D, F).

A. INSTRUCTIONS FOR QUOTING THE CATALOGUE

1. DIMENSIONS

Dimensions of the parts in this catalogue are indicated in unit millimeters.

2. ABBREVIATIONS

Abbreviations used in this catalogue are as follows:

| | | | |
|---------|------------------------|--------------------------|-------------------|
| AR | : As required | NT | : Number of teeth |
| ASSY | : Assembly | OPT | : Optional |
| E.No. | : Engine Number | OS | : Over Size |
| F.No. | : Frame Number | STD | : Standard |
| d | : Diameter of material | T | : Thickness |
| ID | : Inside diameter | US | : Under size |
| OD | : Outside diameter | W | : Width |
| L | : Length | S,L,UL,LL : Transom type | |
| LH | : Left hand side | | |
| RH | : Right hand side | | |
| ~100045 | : Up to F.No.-100045 | | |
| 100046~ | : From F.No.-100046 | | |

12 x 34 x 5.6Figures in the description column show the dimensions of parts.

| | | |
|----|----|-----------|
| | | |
| ID | OD | T(or W,L) |

To 12340-56781 (Parts No.) : indicates that the parts number was changed to 12345-56781 and the new parts are interchangeable with the former ones but the former ones are not interchangeable with new ones.

From 12345-56781 (Parts No.) : indicates that the former and new parts are interchangeable with each other and both are usable.

The number of letter shown below Q'ty indicate the MODEL NAME as shown right side.

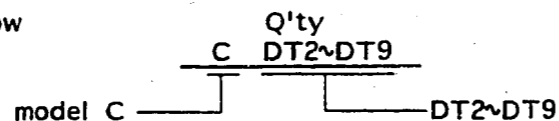

3. INNER PARTS OF ASSEMBLY

Parts number that have a period (.) mark in front of the part description on a text page are separately serviced parts of the assembly.

4. MODIFICATION NOTICE

A parts bulletin will be sent to you on all occasions when changes in parts occur, including interchangeable modifications between new parts and old ones.

5. NOTE

5-1. There are some different parts from those of production models among spare parts for the administrative reasons and common use of them with other models.

5-2. In respect of rubber hoses and vinyl tubes, please be sure to use them by cutting off according to the length mentioned on parts catalogue or what is actually required on the vehicle.

5-3. Note that the drawings on the illustration page are for ready reference of spare parts number, not to be used as an assembly manual.
When assembling, use "SUZUKI SERVICE MANUAL".

6. SPECIFICATION CODE

This catalogue contains the parts for the model designed for the following spec.;

spec. code: DT2C (E1, E28), DT2D (E1), DT2F (E1), DT3.5F (E1, E16), DT4.5C (E1, E28), DT4D (E1), DT5D (E1, E3, E13), DT5F (E1, E3, E13), DT7.5C (E1, E13, E28), DT7.5D (E1, E13), DT7.5F (E1, E9, E13), DT9C (E1, E13, E28, E37), DT9D (E1, E13), DT9F (E1, E9, E13)

7. SERIAL FRAME NUMBER

C-10001~, D-10001~, F-10001~

FIG.1

B - 3

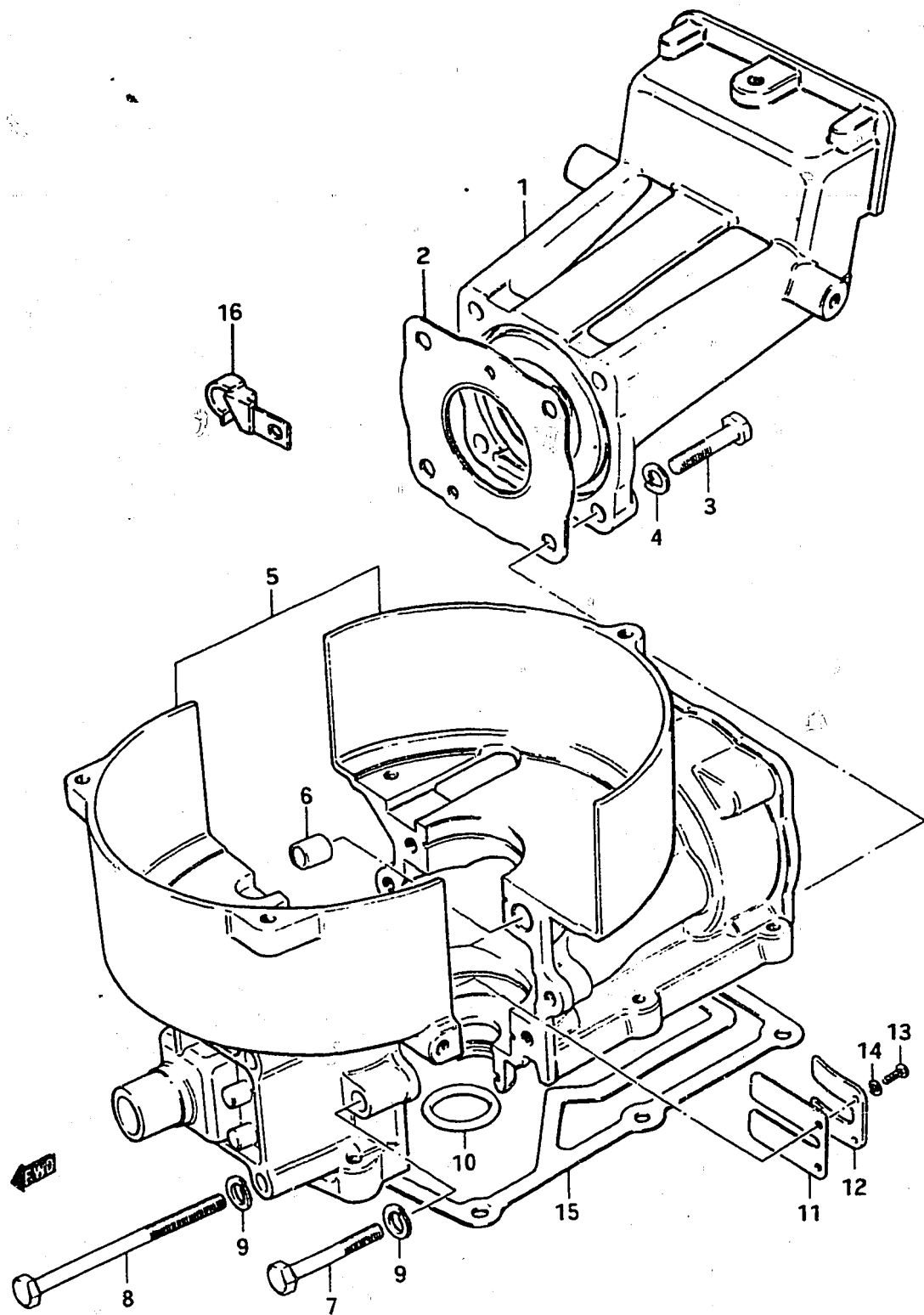

FIG.1 CYLINDER

| Ref. No. | Part No. | Description | Q'ty | | | Remarks |
|----------|-----------------|-----------------------------|------|---|---|--------------------|
| | | | C | D | F | |
| 1-1 | 11111-98400-01J | CYLINDER HEAD | 1 | 1 | - | to 11111-98401-01J |
| 1-2 | 11111-98401-01J | CYLINDER HEAD | - | - | 1 | to 11111-98402-01J |
| 2 | 11141-98400 | GASKET, cylinder head | 1 | 1 | 1 | |
| 3 | 01107-06308 | BOLT | 4 | 4 | 4 | |
| 4 | 08321-21068 | LOCK WASHER | 4 | 4 | 4 | |
| 5-1 | 11300-98840-01J | CYLINDER/CRANKCASE ASSY | 1 | 1 | - | to 11300-98841-01J |
| 5-2 | 11300-98841-01J | CYLINDER/CRANKCASE ASSY | - | - | 1 | to 11300-98842-01J |
| 5-3 | 11300-98842-01J | CYLINDER/CRANKCASE ASSY | - | - | 1 | to 11300-98400-01J |
| 6 | 04211-09109 | •DOWEL PIN | 2 | 2 | 2 | |
| 7 | 01107-06358 | •BOLT | 2 | 2 | 2 | |
| 8 | 09100-06062 | •BOLT (6x70) | 4 | 4 | 4 | |
| 9 | 08321-21068 | •LOCK WASHER | 6 | 6 | 6 | |
| 10 | 09280-20002 | O RING, cylinder | 1 | 1 | 1 | ID:19.4,d:3.1 |
| 11 | 13153-19012 | VALVE, reed | 1 | 1 | 1 | |
| 12 | 13152-19010 | STOPPER, reed valve | 1 | 1 | 1 | |
| 13 | 02112-03088 | SCREW | 2 | 2 | 2 | |
| 14 | 08321-21038 | LOCK WASHER | 2 | 2 | 2 | |
| 15 | 52113-98400 | GASKET, drive shaft housing | 1 | 1 | 1 | |
| 16 | 09403-10309 | CLAMP | - | - | 1 | |

FIG.2

B - 4

FIG.2 PISTON - CRANKSHAFT

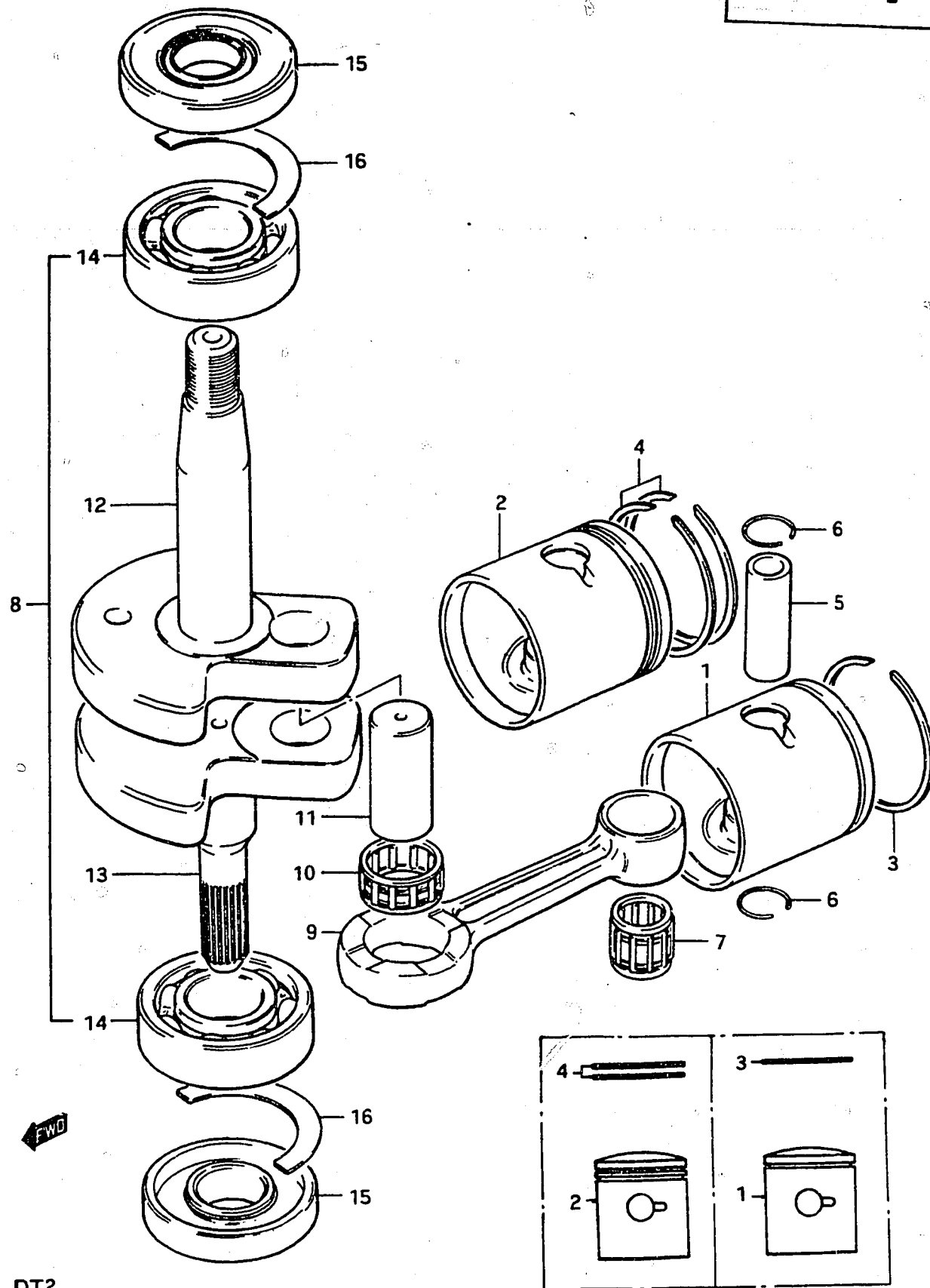

| Ref. No. | Part No. | Description | Q'ty | | | Remarks |
|----------|-----------------|--|------|---|---|----------------------------------|
| | | | C | D | F | |
| 1-1 | 12110-98401 | PISTON (to 12110-98400) | 1 | 1 | - | to (12110-98402) + (12140-98400) |
| 1-2 | 12110-98700 | PISTON to (12110-98402-025)+(12140-98400-025) | 1 | 1 | - | OS:0.25,OPT |
| 1-3 | 12110-98710 | PISTON to (12110-98402-050)+(12140-46110-050) | 1 | 1 | - | OS:0.5,OPT |
| 2-1 | 12110-98402 | PISTON | - | - | 1 | |
| 2-2 | 12110-98402-025 | PISTON | - | - | 1 | OS:0.25,OPT |
| 2-3 | 12110-98402-050 | PISTON | - | - | 1 | OS:0.5,OPT |
| 3-1 | 12141-35010 | RING, piston | 1 | 1 | - | |
| 3-2 | 12141-35010-025 | RING, piston | 1 | 1 | - | OS:0.25,OPT from 12141-98700 |
| 3-3 | 12141-35010-050 | RING, piston | 1 | 1 | - | OS:0.5,OPT from 12141-35700 |
| 4-1 | 12140-98400 | RING SET, piston | - | - | 1 | |
| 4-2 | 12140-98401-025 | RING SET, piston | - | - | 1 | OS:0.25,OPT |
| 4-3 | 12140-98401-050 | RING SET, piston | - | - | 1 | OS:0.5,OPT |
| 5 | 12151-02000 | PIN, piston | 1 | 1 | 1 | |
| 6 | 09381-12001 | CIRCLIP, piston pin | 2 | 2 | 2 | |
| 7 | 09263-12003 | BEARING, piston pin | 1 | 1 | 1 | 12x16x15.8 |
| 8 | 12200-98401 | CRANKSHAFT ASSY | 1 | 1 | 1 | from 12200-98830 |
| 9 | 12161-98400 | •ROD, connecting | 1 | 1 | 1 | |
| 10 | 09263-15014 | •BEARING, crank pin | 1 | 1 | 1 | 15x21x9.8 from 09263-15005 |
| 11 | 12211-04000 | •PIN, crank | 1 | 1 | 1 | |
| 12 | 12221-98400 | •CRANKSHAFT, upper | 1 | 1 | 1 | |
| 13 | 12231-98400 | •CRANKSHAFT, lower | 1 | 1 | 1 | |
| 14 | 09262-17008 | •BEARING | 2 | 2 | 2 | from 08113-62030 |
| 15 | 09283-17002 | OIL SEAL, crankshaft | 2 | 2 | 2 | 17x40x7 |
| 16 | 09390-40003 | RING, thrust | 2 | 2 | 2 | |

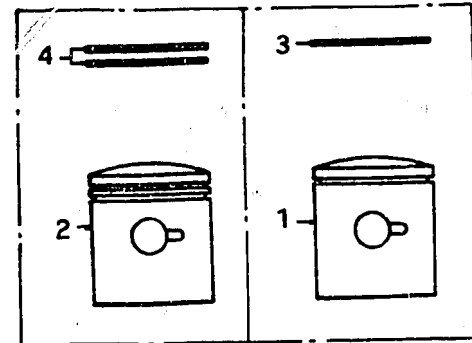

FIG.3

B - 5

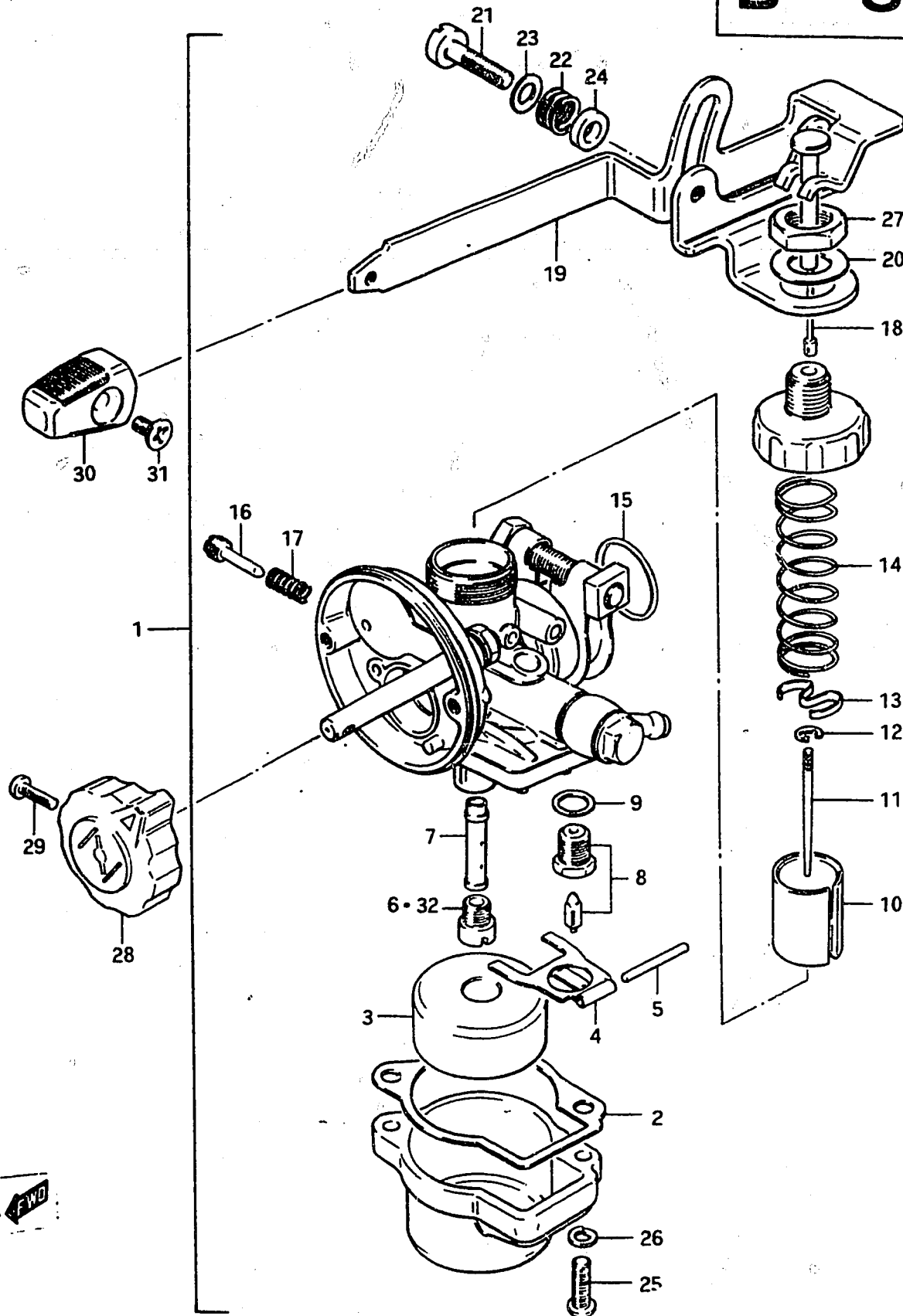

FIG.3 CARBURETOR (Up to E.No.DT2C-13855)

| Ref. No. | Part No. | Description | Q'ty | Remarks |
|----------|-------------|------------------------------|------|------------------|
| 1 | 13200-98410 | CARBURETOR ASSY | 1 | to 13200-98411 |
| 2 | 13251-98410 | •GASKET, float chamber | 1 | |
| 3 | 13252-98410 | •FLOAT | 1 | |
| 4 | 13253-98410 | •ARM, float | 1 | |
| 5 | 13254-98410 | •PIN, float | 1 | |
| 6 | 09491-95004 | •JET, main | 1 | 95 |
| 7 | 09494-00179 | •NOZZLE, needle | 1 | |
| 8 | 13370-23010 | •VALVE ASSY, needle | 1 | VS:1.5 |
| 9 | 13392-01010 | •GASKET, valve seat | 1 | |
| 10 | 13551-98410 | •VALVE, throttle | 1 | CA:1.5 |
| 11 | 13383-98410 | •NEEDLE, jet | 1 | |
| 12 | 13394-12110 | •CLIP, needle | 1 | |
| 13 | 13581-01010 | •SEAT, throttle valve spring | 1 | |
| 14 | 13573-35010 | •SPRING, throttle valve | 1 | |
| 15 | 13295-98410 | •O RING | 1 | |
| 16 | 13267-01010 | •SCREW, throttle stop | 1 | |
| 17 | 13268-01010 | •SPRING, stop screw | 1 | |
| 18 | 13560-98410 | •CABLE, throttle | 1 | |
| 19 | 13564-98410 | •LEVER ASSY, throttle | 1 | |
| 20 | 13589-98410 | •WASHER | 1 | to 13589-98411 |
| 21 | 13433-98410 | •SCREW | 1 | from 13433-33110 |
| 22 | 13426-98410 | •SPRING WASHER | 1 | from 13426-43010 |
| 23 | 13615-98412 | •WASHER | 1 | from 13615-43010 |
| 24 | 13432-33110 | •RING, friction | 1 | |
| 25 | 02112-04168 | •SCREW | 2 | |
| 26 | 08321-21048 | •LOCK WASHER | 2 | |
| 27 | 13567-98410 | •NUT | 1 | to 13567-98411 |
| 28 | 13631-98400 | KNOB, chock | 1 | |
| 29 | 02111-03108 | SCREW | 1 | |
| 30 | 88851-64000 | KNOB, throttle link | 1 | |
| 31 | 02122-03068 | SCREW | 1 | |
| 32 | 09491-20013 | JET, main | 1 | OPT 100 |

FIG.4 (B-6,7) : DT2C-13856~, DT2D, DT2F

FIG.4

B - 6

FIG.4 CARBURETOR (From E.No.DT2C-13856)

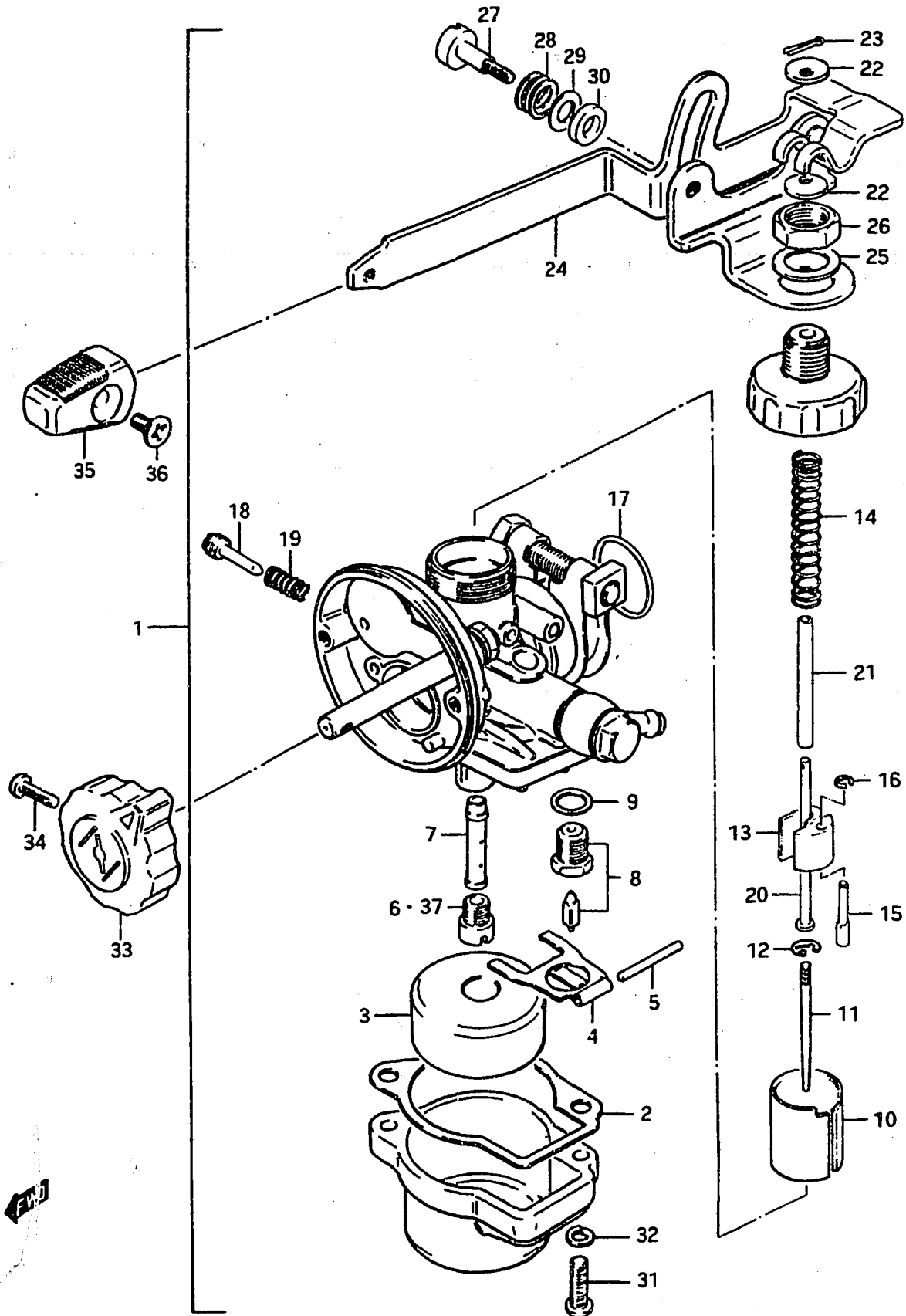

| Ref. No. | Part No. | Description | Q'ty | | | Remarks |
|----------|-------------|------------------------------|------|---|---|----------------|
| | | | C | D | F | |
| 1 | 13200-98411 | CARBURETOR ASSY | 1 | 1 | 1 | |
| 2 | 13251-98410 | •GASKET, float chamber | 1 | 1 | 1 | |
| 3 | 13252-98410 | •FLOAT | 1 | 1 | 1 | |
| 4 | 13253-98410 | •ARM, float | 1 | 1 | 1 | |
| 5 | 13254-98410 | •PIN, float | 1 | 1 | 1 | |
| 6 | 09491-95004 | •JET, main | 1 | 1 | 1 | 95 |
| 7 | 09494-00179 | •NOZZLE, needle | 1 | 1 | 1 | |
| 8 | 13370-23010 | •VALVE ASSY, needle | 1 | 1 | 1 | VS:1.5 |
| 9 | 13392-01010 | •GASKET, valve seat | 1 | 1 | 1 | |
| 10 | 13551-98411 | •VALVE, throttle | 1 | 1 | 1 | CA:1.5 |
| 11 | 13383-98410 | •NEEDLE, jet | 1 | 1 | 1 | |
| 12 | 13394-12110 | •CLIP, needle | 1 | 1 | 1 | |
| 13 | 13545-98410 | •SEAT, throttle valve spring | 1 | 1 | 1 | |
| 14 | 13573-98411 | •SPRING, throttle valve | 1 | 1 | 1 | to 13573-98410 |
| 15 | 13563-98410 | •PIN, spring seat | 1 | 1 | 1 | |
| 16 | 13533-98410 | •E RING, spring seat pin | 1 | 1 | 1 | |
| 17 | 13295-98410 | •O RING | 1 | 1 | 1 | |
| 18 | 13267-01010 | •SCREW, throttle stop | 1 | 1 | 1 | |
| 19 | 13268-01010 | •SPRING, stop screw | 1 | 1 | 1 | |
| 20 | 13552-98410 | •ROD, throttle | 1 | 1 | 1 | |
| 21 | 13552-98411 | •PIPE, throttle rod | 1 | 1 | 1 | |
| 22 | 13557-98410 | •PLATE, throttle rod | 2 | 2 | 2 | |
| 23 | 04111-12108 | •COTTER PIN | 1 | 1 | 1 | |

FIG.3 (B-5) : ~DT2C-13855

FIG.4

B - 7

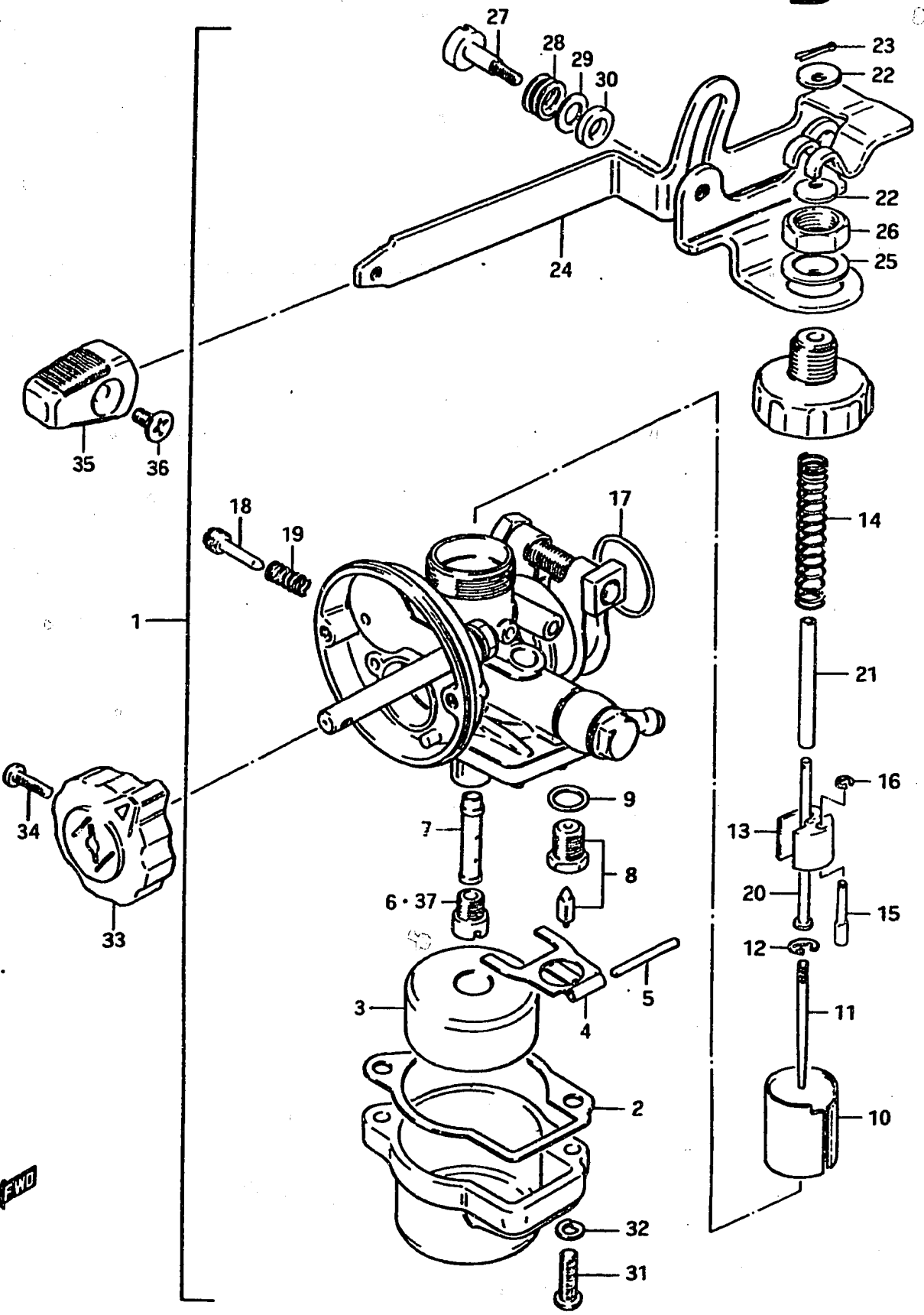

FIG.4 CARBURETOR (From E.No.DT2C-13856)

| Ref. No. | Part No. | Description | Q'ty | | | Remarks |
|----------|-------------|-----------------------|------|---|---|----------------|
| | | | C | D | F | |
| 24 | 13564-98411 | •LEVER ASSY, throttle | 1 | 1 | 1 | |
| 25 | 13589-98411 | •WASHER | 1 | 1 | 1 | |
| 26 | 13567-98411 | •NUT | 1 | 1 | 1 | to 13567-98412 |
| 27 | 13433-98410 | •SCREW | 1 | 1 | 1 | |
| 28 | 13426-98410 | •SPRING WASHER | 1 | 1 | 1 | |
| 29 | 13615-98412 | •WASHER | 1 | 1 | 1 | |
| 30 | 13432-33110 | •RING, friction | 1 | 1 | 1 | |
| 31 | 02112-04168 | •SCREW | 2 | 2 | 2 | |
| 32 | 08321-21048 | •LOCK WASHER | 2 | 2 | 2 | |
| 33 | 13631-98400 | KNOB, chock | 1 | 1 | 1 | |
| 34 | 02111-03108 | SCREW | 1 | 1 | 1 | |
| 35 | 88851-64000 | KNOB, throttle link | 1 | 1 | 1 | |
| 36 | 02122-03068 | SCREW | 1 | 1 | 1 | |
| 37 | 09491-20013 | JET, main | 1 | 1 | 1 | OPT,100 |

FIG.3 (B-5) : ~DT2C-13855



FIG.5

B - 8

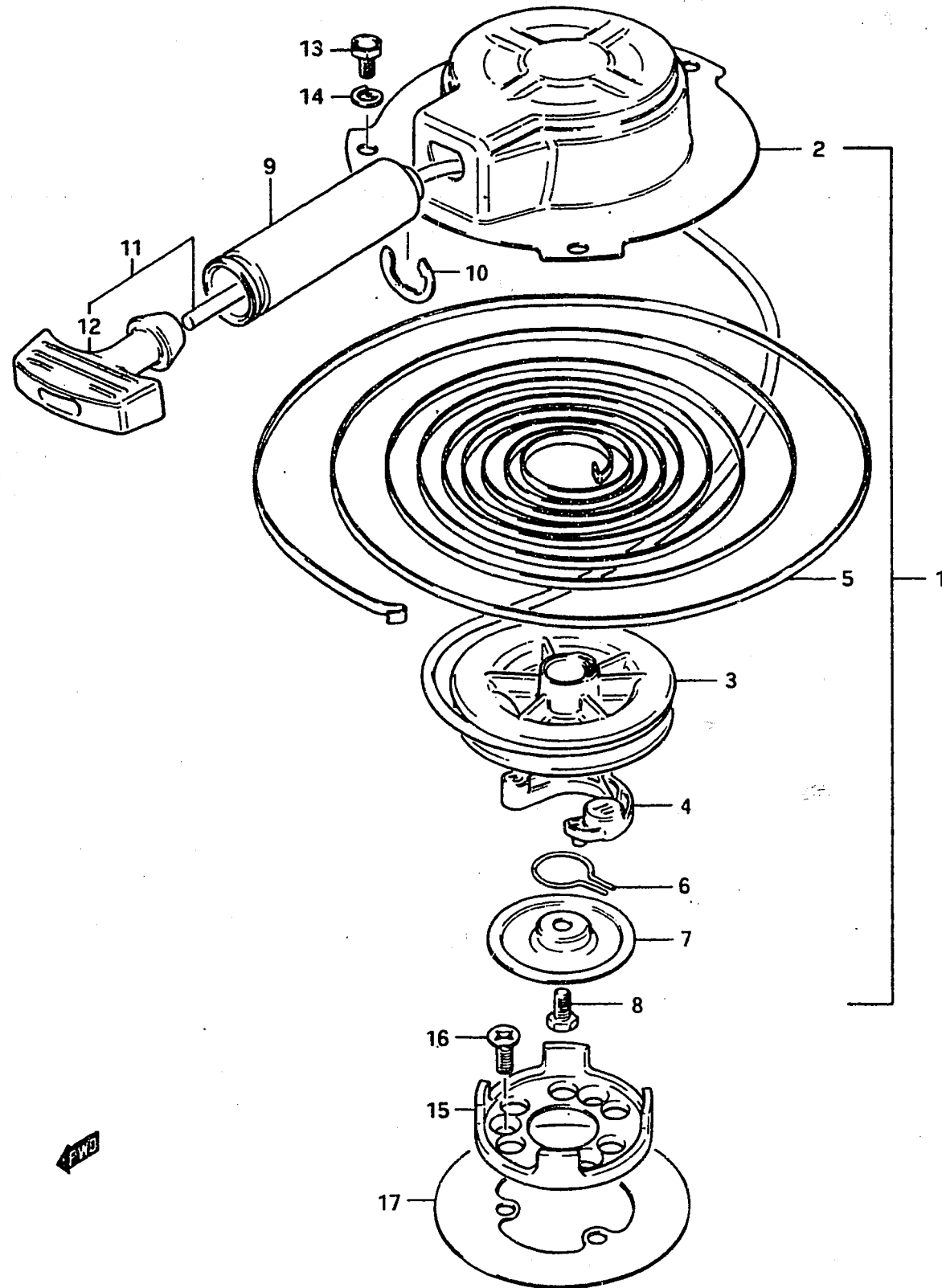

6

FIG.5 STARTER

| Ref. No. | Part No. | Description | Q'ty | | | Remarks |
|----------|-------------|----------------------|------|---|---|------------------|
| | | | C | D | F | |
| 1-1 | 18100-98400 | STARTER, recoil | 1 | 1 | - | to 18100-98401 |
| 1-2 | 18100-98401 | STARTER, recoil | - | 1 | 1 | DT2D-12056~ |
| 2 | 18111-98400 | •CASE, starter | 1 | 1 | 1 | |
| 3 | 18121-98400 | •DRUM, sheave | 1 | 1 | 1 | |
| 4 | 18131-98400 | •PAWL, drive | 1 | 1 | 1 | |
| 5 | 18142-98400 | •SPRING, recoil | 1 | 1 | 1 | |
| 6 | 18153-98410 | •SPRING, pilot shaft | 1 | 1 | 1 | from 18145-98400 |
| 7 | 18151-98400 | •PLATE | 1 | 1 | 1 | |
| 8 | 18332-98400 | •BOLT, pivot | 1 | 1 | 1 | from 18153-98400 |
| 9 | 18181-98400 | •GUIDE, rope | 1 | 1 | 1 | |
| 10 | 18183-98400 | •E RING | 1 | 1 | 1 | |
| 11-1 | 18170-98400 | •GRIP ASSY, starter | 1 | 1 | - | to 18170-98401 |
| 11-2 | 18200-98401 | •GRIP ASSY, starter | - | 1 | 1 | from 18170-98401 |
| 12-1 | 18211-98400 | ••GRIP | 1 | 1 | - | to 18210-98400 |
| 12-2 | 18210-98400 | ••GRIP | - | 1 | 1 | |
| 13 | 01107-06108 | BOLT | 2 | 2 | 2 | |
| 14 | 08321-21068 | LOCK WASHER | 2 | 2 | 2 | |
| 15-1 | 18411-98400 | CUP, starter | 1 | - | - | to 18411-98401 |
| 15-2 | 18411-98401 | CUP, starter | - | 1 | 1 | |
| 16 | 02122-06128 | SCREW | 3 | 3 | 3 | |
| 17 | 32725-93400 | INSULATOR, magneto | 1 | 1 | 1 | |

FIG.6

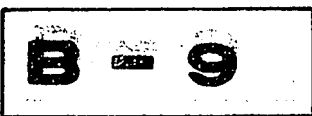
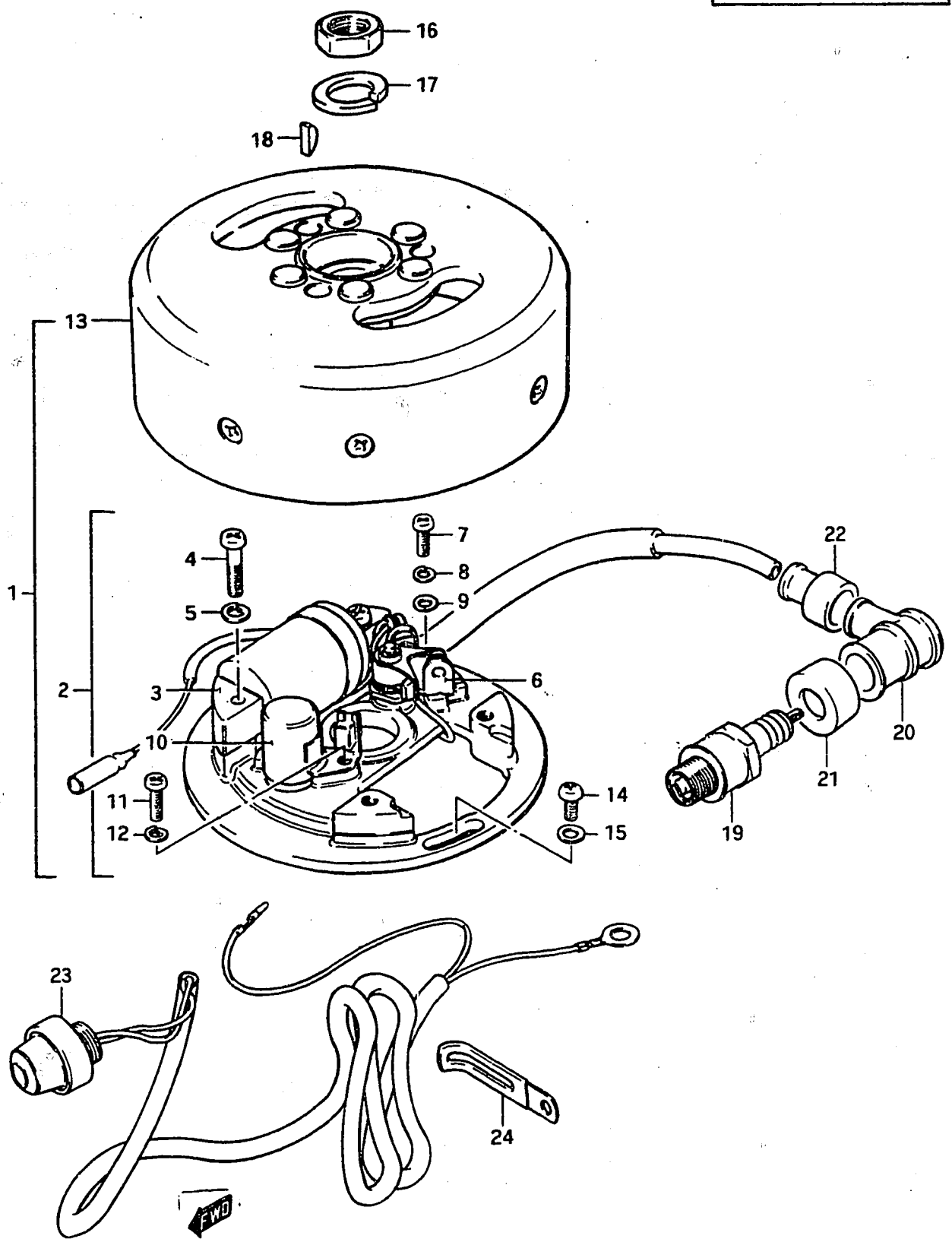

FIG.6 ELECTRICAL



| Ref. No. | Part No. | Description | Q'ty | | | Remarks |
|----------|-------------|------------------------------|------|---|---|----------------------------------|
| | | | C | D | F | |
| 1 | 32100-98431 | MAGNETO ASSY | 1 | 1 | 1 | from 32100-98430 |
| 2 | 32101-98433 | •STATOR ASSY | 1 | 1 | 1 | from 32101-98432 to 32101-98434 |
| 3 | 32140-98431 | ••COIL, ignition | 1 | 1 | 1 | from 32140-98430 |
| 4 | 02112-05258 | ••SCREW | 2 | 2 | 2 | |
| 5 | 08321-21058 | ••LOCK WASHER | 2 | 2 | 2 | |
| 6 | 32240-98034 | ••POINT ASSY, contact | 1 | 1 | 1 | from 32240-98033 |
| 7 | 02311-04108 | ••SCREW | 1 | 1 | 1 | |
| 8 | 08321-21048 | ••LOCK WASHER | 1 | 1 | 1 | |
| 9 | 08322-21048 | ••WASHER | 1 | 1 | 1 | |
| 10 | 32341-98430 | ••CONDENSER | 1 | 1 | 1 | |
| 11 | 02112-04108 | ••SCREW | 1 | 1 | 1 | |
| 12 | 08321-21048 | ••LOCK WASHER | 1 | 1 | 1 | |
| 13 | 32102-98431 | •ROTOR ASSY | 1 | 1 | 1 | from 32102-98430 |
| 14 | 02112-05128 | SCREW | 2 | 2 | 2 | |
| 15 | 08322-21058 | WASHER | 2 | 2 | 2 | |
| 16 | 08310-22128 | NUT | 1 | 1 | 1 | |
| 17 | 08321-21128 | LOCK WASHER | 1 | 1 | 1 | |
| 18 | 08341-31039 | KEY | 1 | 1 | 1 | |
| 19-1 | 09482-00011 | SPARK PLUG ASSY | 1 | - | - | B-4H,NGK |
| 19-2 | 09482-00142 | SPARK PLUG ASSY | - | 1 | - | B-4H,NGK ~DT2D-13087 |
| 19-3 | 09482-00113 | SPARK PLUG ASSY | 1 | - | - | E28,BR-5HS,NGK to 09482-00143 |
| 19-4 | 09482-00143 | SPARK PLUG ASSY | - | 1 | 1 | BR-5HS,NGK DT2D-13088~ |
| 20-1 | 33510-28300 | CAP, spark plug | 1 | - | - | |
| 20-2 | 33510-41111 | CAP, spark plug | - | 1 | 1 | to 33510-95510 |
| 21 | 33541-98001 | SEAL, spark plug | 1 | - | - | to 33541-98002 |
| 22 | 33542-98000 | SEAL, high tension cord | 1 | - | - | |
| 23-1 | 37800-99014 | SWITCH ASSY, engine stop | 1 | - | - | to 37800-99015 |
| 23-2 | 37800-99015 | SWITCH ASSY, engine stop | - | 1 | 1 | to 37800-99016 |
| 23-3 | 37800-93350 | SWITCH ASSY, engine stop | - | - | 1 | from 37800-99016 |
| 24-1 | 09404-06414 | CLAMP, stop switch read cord | 1 | - | - | |
| 24-2 | 09404-06413 | CLAMP, stop switch read cord | - | 1 | 1 | |

FIG.7

B - 10

FIG.7 CLAMP BRACKET - SWIVEL BRACKET

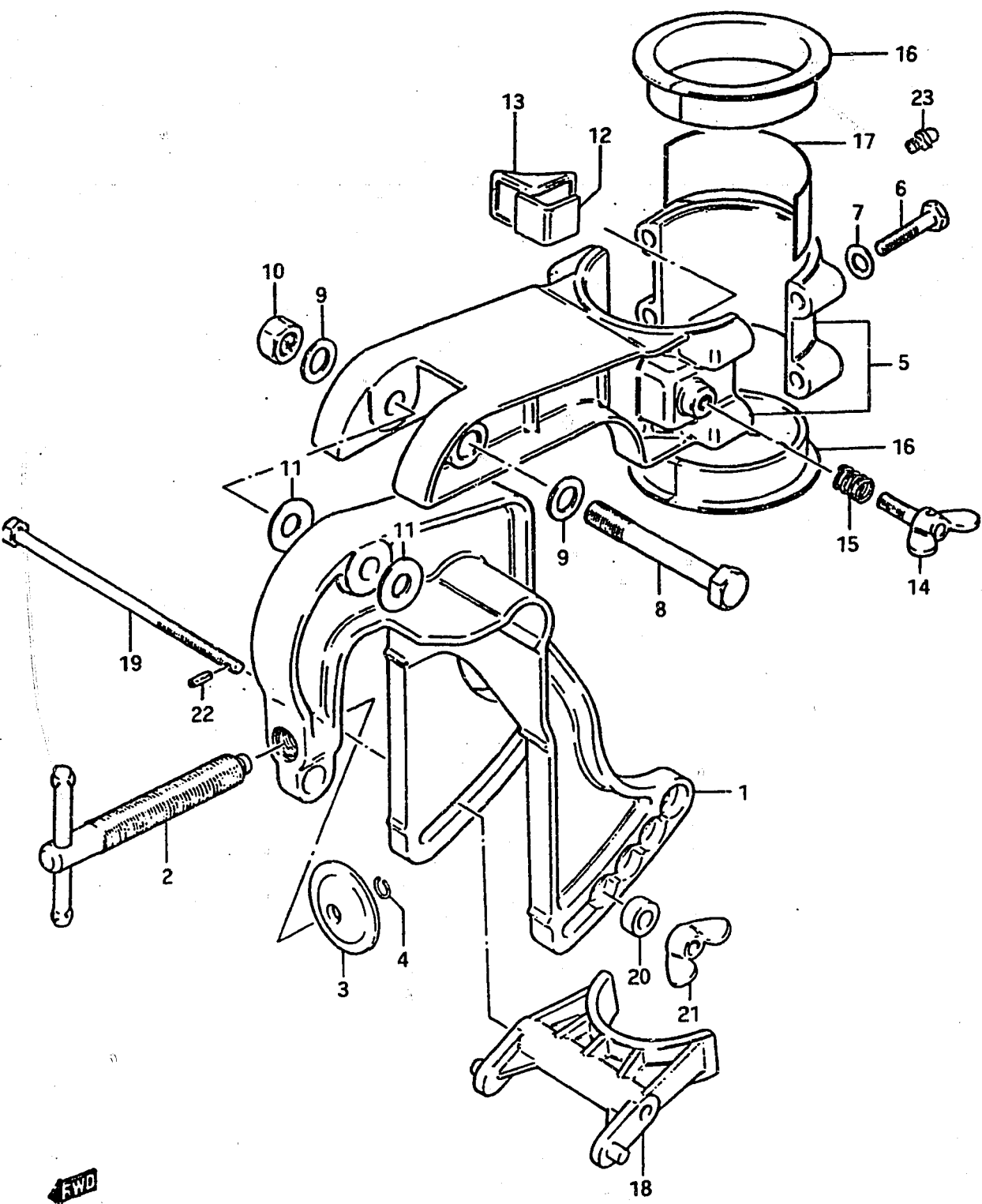

| Ref. No. | Part No. | Description | Q'ty | | | Remarks |
|----------|-----------------|---------------------------|------|---|---|---|
| | | | C | D | F | |
| 1 | 41111-98400-01J | BRACKET, clamp | 1 | 1 | 1 | to 41111-98401-01J |
| 2 | 41210-98400 | SCREW, clamp | 1 | 1 | 1 | |
| 3 | 41213-99001 | PLATE, clamp | 1 | 1 | 1 | |
| 4 | 09380-07001 | RING, clamp plate | 1 | 1 | 1 | |
| 5-1 | 43110-98401-01J | BRACKET ASSY, swivel | 1 | 1 | 1 | from 43110-98400-01J to 43110-98402-01J |
| 5-2 | 43110-98402-01J | BRACKET ASSY, swivel | - | - | 1 | to (43110-98404-01J) + (22511-99000) |
| 5-3 | 43110-98404-01J | BRACKET ASSY, swivel | - | - | 1 | to 43110-98405-01J |
| 6 | 09100-06049 | BOLT, swivel (6x30) | 4 | 4 | 4 | |
| 7 | 09160-06015 | WASHER, swivel (6.5x13x1) | 4 | 4 | 4 | |
| 8 | 09100-08131 | BOLT, swivel shaft (8x12) | 1 | 1 | 1 | |
| 9 | 09160-08015 | WASHER, swivel shaft | 2 | 2 | 2 | 8.5x16x1.2 |
| 10 | 09159-08018 | NUT, swivel shaft | 1 | 1 | 1 | |
| 11 | 09160-08014 | WASHER, tilt friction | 2 | 2 | 2 | 8.5x23x1.5 |
| 12 | 43415-98401 | PLATE, steering adjuster | 1 | 1 | 1 | |
| 13 | 43416-98401 | RUBBER, steering adjuster | 1 | 1 | 1 | |
| 14 | 09119-06038 | BOLT, steering adjuster | 1 | 1 | 1 | |
| 15 | 09440-09009 | SPRING, steering adjuster | 1 | 1 | 1 | to 09440-09012 |
| 16-1 | 43711-98400 | BUSHING, steering | 2 | 2 | - | to 43711-98401 |
| 16-2 | 43711-98401 | BUSHING, steering | - | 2 | 2 | DT2D-13472~ |
| 17 | 43125-98400 | PLATE, back up | - | 1 | 1 | |
| 18 | 45411-98400 | BLOCK, thrust | 1 | 1 | 1 | to 45411-98401 |
| 19 | 09101-06006 | BOLT, tilt lock (6x115) | 1 | 1 | 1 | |
| 20 | 09180-06070 | SPACER, tilt lock | 1 | 1 | 1 | 6.5x13.5x9.5 |
| 21 | 09144-06004 | WING NUT, tilt lock | 1 | 1 | 1 | |
| 22 | 09205-03010 | PIN, tilt lock (3x6) | 1 | 1 | 1 | |
| 23 | 22511-99000 | GREASE NIPPLE | - | - | 1 | |

FIG. 8

B - 11

FIG. 8 DRIVE SHAFT HOUSING - GEAR CASE - HANDLE

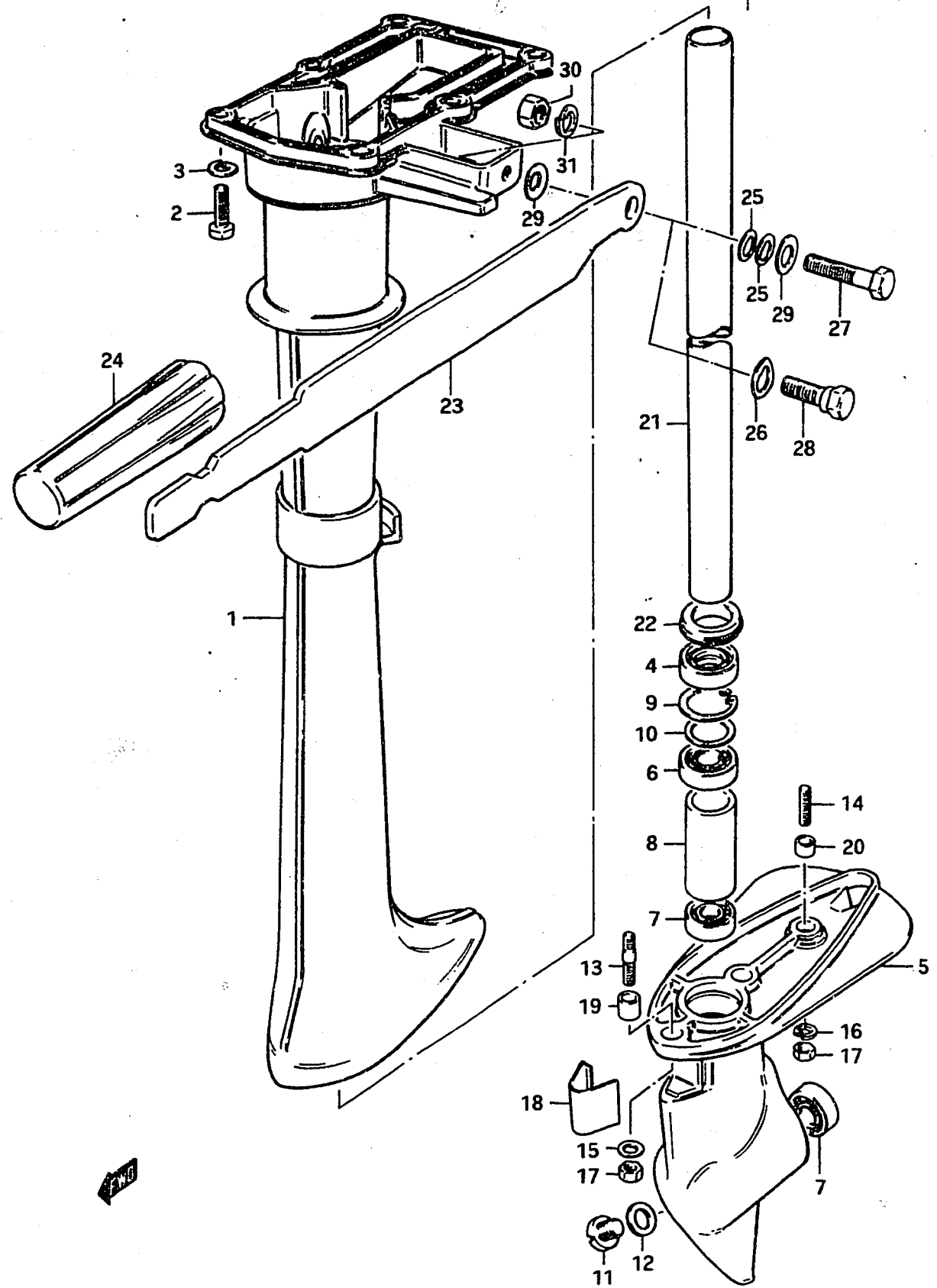

| Ref. No. | Part No. | Description | Q'ty | | | Remarks |
|----------|--|-------------------------------|---------|---|---|---|
| | | | C | D | F | |
| 1 | 52111-98401-01J | HOUSING, drive shaft | 1 | 1 | 1 | from 52111-98400-01J |
| 2 | 09100-06020 | BOLT (6x20) | 6 | 6 | 6 | |
| 3 | 09162-06001 | LOCK WASHER | 6 | 6 | 6 | |
| 4 | 09289-12002 | OIL SEAL, drive shaft housing | 1 | 1 | 1 | 12x28x8 |
| 5 | 55100-98811-01J | CASE SET, gear | 1 | 1 | 1 | from 55100-98810-01J to 55110-98401-01J |
| 6 | 09262-12001 | ·BEARING, drive shaft | 1 | 1 | 1 | 12x28x8 |
| 7 | 08113-60000 | ·BEARING | 2 | 2 | 2 | |
| 8 | 09180-19004 | ·SPACER, drive shaft bearing | 1 | 1 | 1 | 19x25.4x1.5 |
| 9 | 08331-21289 | CIRCLIP | 1 | 1 | 1 | |
| 10-1 | 08221-22283 | SHIM, bearing (T:0.1) | AR(0~2) | | | |
| 10-2 | 08221-22284 | SHIM, bearing (T:0.2) | AR(0~2) | | | |
| 11 | 09248-10003 | PLUG, drain | 1 | 1 | 1 | |
| 12 | 09168-10004 | GASKET, drain plug (10x17x2) | 1 | 1 | 1 | to 09168-10022 |
| 13 | 09108-06032 | STUD BOLT, gear case 1 | 1 | 1 | 1 | 6x20 |
| 14 | 09108-06022 | STUD BOLT, gear case 2 | 1 | 1 | 1 | 6x12 |
| 15 | 09160-06015 | WASHER (6.5x16x2.3) | 1 | 1 | 1 | |
| 16 | 09162-06001 | LOCK WASHER | 1 | 1 | 1 | |
| 17 | 09140-06004 | NUT | 2 | 2 | 2 | |
| 18 | 53131-98400-01J | COVER, gear case bolt | 1 | 1 | 1 | |
| 19 | 09206-09001 | PIN (9x10) | 1 | 1 | 1 | |
| 20 | 09206-09007 | PIN (9x5) | 1 | 1 | 1 | |
| 21 | 57151-98400 | PIPE, drive shaft seal | 1 | 1 | 1 | |
| 22 | 09305-20001 | BUSHING, seal pipe | 1 | 1 | 1 | |
| 23-1 | 63111-98400-01J | HANDLE, tiller | 1 | - | - | |
| 23-2 | 63111-98700-01J | HANDLE, tiller | 1 | - | - | OPT |
| | to (63111-98401-01J)+(09111-08033)+(09164-10006) | | | | | |
| 23-3 | 63111-98401-01J | HANDLE, tiller | - | 1 | 1 | to 63111-98402-01J |
| 24 | 63211-98400 | GRIP, handle | 1 | 1 | 1 | |
| 25 | 09164-08010 | WASHER, handle pivot 1 | 2 | - | - | |
| 26 | 09164-10006 | WASHER, handle pivot 1 | - | 1 | 1 | |
| 27 | 09100-08112 | BOLT, handle pivot (8x30) | 1 | - | - | |
| 28 | 09111-08033 | BOLT, handle pivot | - | 1 | 1 | |
| 29 | 09160-08014 | WASHER, handle pivot 2 | 2 | 1 | 1 | |
| 30 | 09140-08003 | NUT, handle pivot | 1 | - | - | |
| 31 | 09162-08003 | LOCK WASHER | 1 | - | - | |

FIG. 9

B - 12

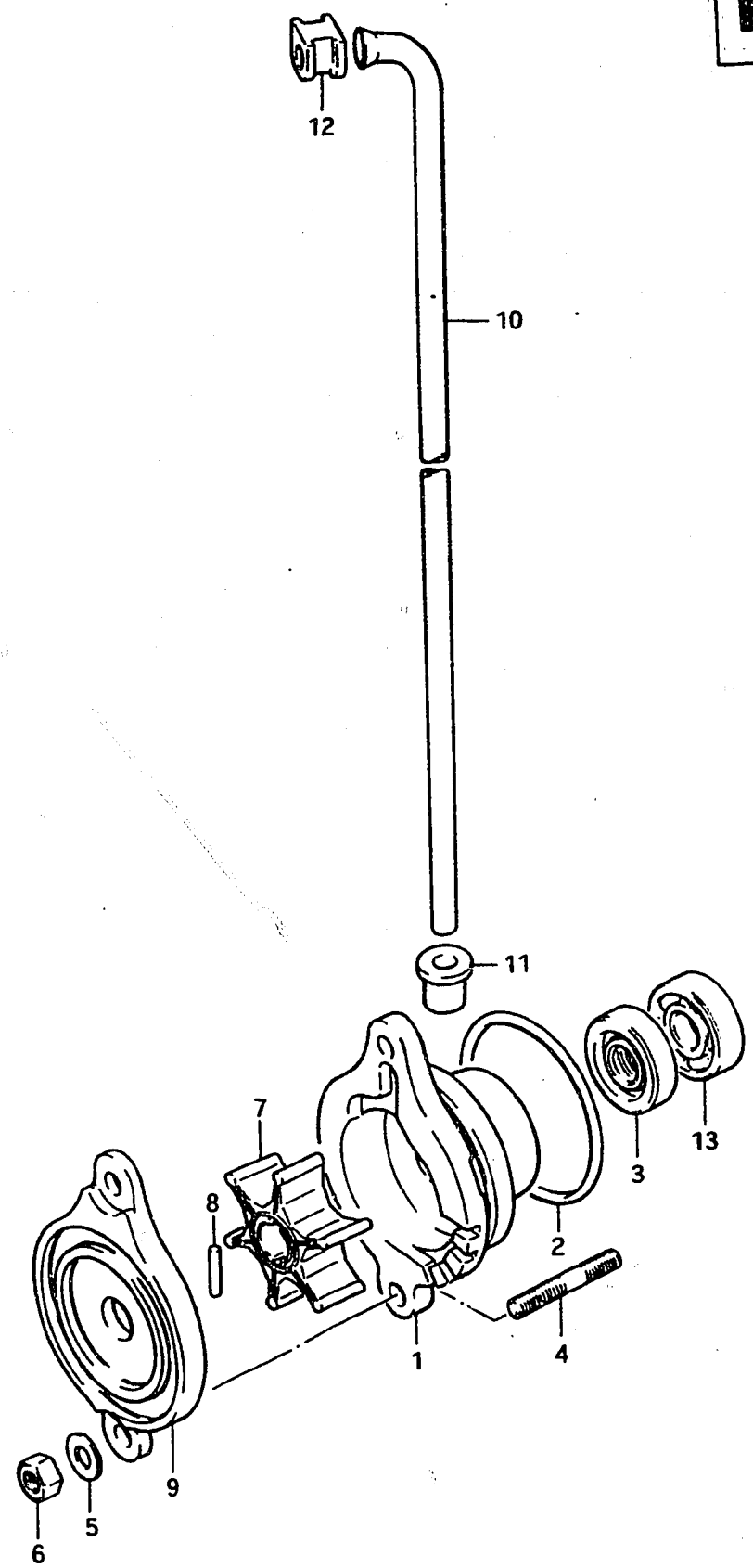

10

FIG. 9 WATER PUMP

| Ref. No. | Part No. | Description | Q'ty | | | Remarks |
|----------|-----------------|-----------------------------|------|---|---|--------------------|
| | | | C | D | F | |
| 1 | 17411-98400-01J | CASE, water pump | 1 | 1 | 1 | to 17410-98400-01J |
| 2 | 09280-48002 | O RING, water pump case | 1 | 1 | 1 | ID:47.4,d:2.6 |
| 3 | 09289-10003 | OIL SEAL, water pump case | 1 | 1 | 1 | 10x26x8 |
| 4 | 09108-06032 | STUD BOLT (6x12) | 2 | 2 | 2 | |
| 5 | 09160-06015 | WASHER (6.5x13x1) | 2 | 2 | 2 | |
| 6 | 09140-06004 | NUT | 2 | 2 | 2 | |
| 7-1 | 17461-98400 | IMPELLER, water pump | 1 | 1 | - | to 17461-98401 |
| 7-2 | 17461-98402 | IMPELLER, water pump | - | - | 1 | from 17461-98401 |
| 8 | 09202-02006 | PIN, pump impeller (2.9x14) | 1 | 1 | 1 | |
| 9 | 17471-98400-01J | COVER, pump case | 1 | 1 | 1 | |
| 10 | 17561-98400 | TUBE, water (L:515) | 1 | 1 | 1 | |
| 11 | 09305-06007 | BUSHING, water tube | 1 | 1 | 1 | |
| 12 | 09309-06005 | GROMMET, water tube | 1 | 1 | 1 | |
| 13 | 08113-60000 | BEARING, propeller shaft | 1 | 1 | 1 | |

FIG. 10

B - 13

FIG.10 TRANSMISSION - PROPELLER

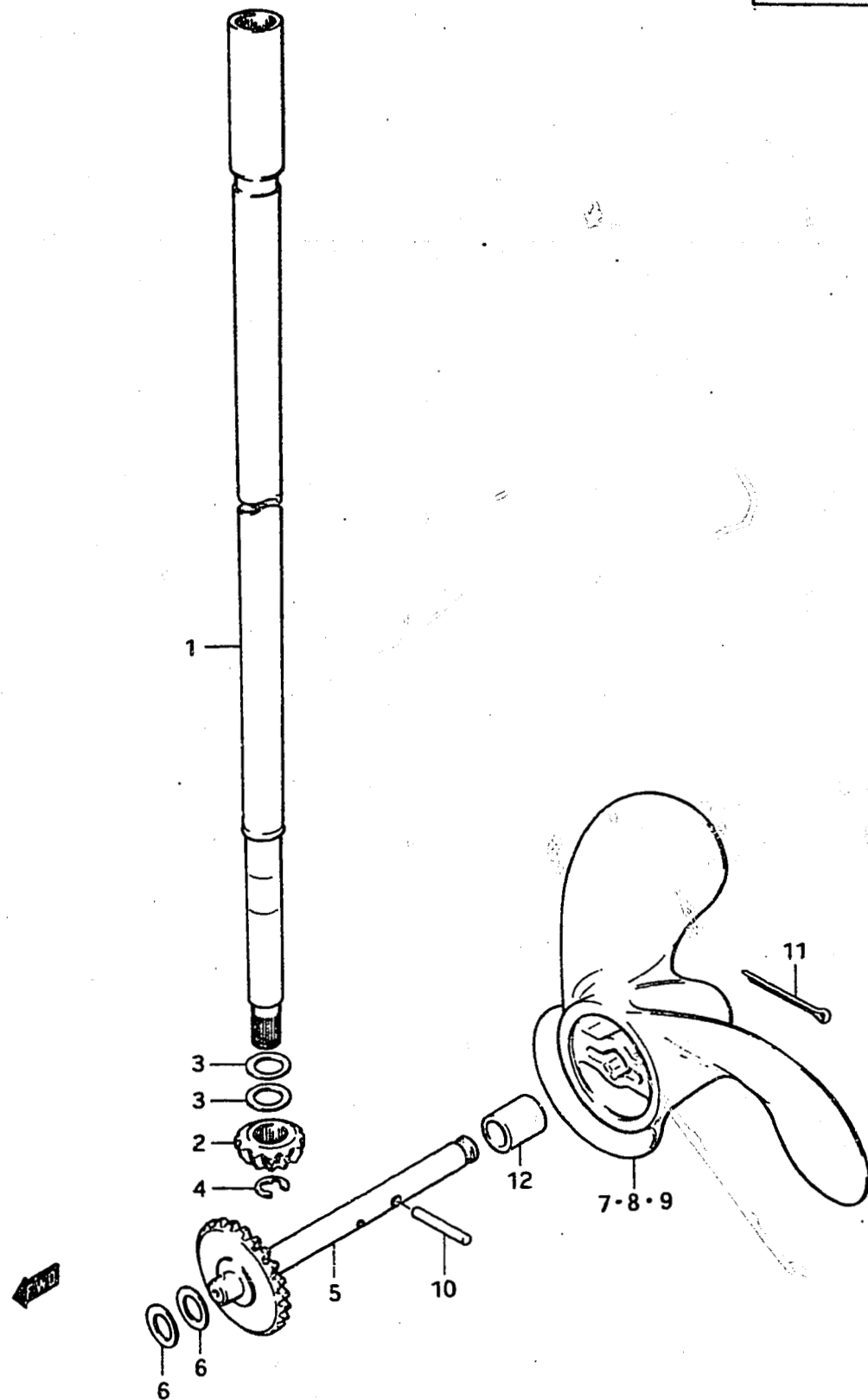

| Ref. No. | Part No. | Description | Q'ty | | | Remarks |
|----------|-----------------|--|---------|---|---|--|
| | | | C | D | F | |
| 1-1 | 57110-98990 | SHAFT, drive to (57110-98400) + (57311-98400) | 1 | - | - | |
| 1-2 | 57110-98400 | SHAFT, drive | - | 1 | 1 | |
| 2-1 | 57311-98990 | PINION | 1 | - | - | |
| 2-2 | 57311-98400 | PINION | - | 1 | 1 | |
| 3-1 | 08221-10165 | SHIM, pinion (T:0.5) | AR(0~2) | | | |
| 3-2 | 08221-10164 | SHIM, pinion (T:0.2) | AR(0~2) | | | |
| 3-3 | 08221-10163 | SHIM, pinion (T:0.1) | AR(0~2) | | | |
| 4 | 08332-11068 | E RING | 1 | 1 | 1 | |
| 5-1 | 57610-98400 | SHAFT, propeller (NT:23) | 1 | - | - | to 57610-98401 |
| 5-2 | 57610-98401 | SHAFT, propeller (NT:23) | - | 1 | 1 | |
| 6-1 | 08221-10165 | SHIM, gear (T:0.5) | AR(0~2) | | | |
| 6-2 | 08221-10164 | SHIM, gear (T:0.2) | AR(0~2) | | | |
| 6-3 | 08221-10163 | SHIM, gear (T:0.1) | AR(0~2) | | | |
| 7-1 | 58111-98400-01T | PROPELLER (3x188x135) | 1 | 1 | - | to 58111-98401-01T |
| 7-2 | 58111-98401-01T | PROPELLER (3x188x135) | - | 1 | 1 | DT2D-11652~ to 58111-98402-01T |
| 8-1 | 58111-98450-01T | PROPELLER (3x188x122) | 1 | 1 | - | to 58111-98451-01T |
| 8-2 | 58111-98451-01T | PROPELLER (3x188x122) | - | 1 | 1 | to 58111-98452-01T |
| 9-1 | 58111-98460-01T | PROPELLER (3x188x115) (STD) | 1 | 1 | - | to 58111-98462-01T |
| 9-2 | 58111-98463-01T | PROPELLER (3x188x115) (STD) | - | 1 | 1 | from 58111-98462-01T to 58111-98464-01T |
| 10 | 09202-04002 | SHEAR PIN (4x24) | 1 | 1 | 1 | |
| 11 | 09204-02001 | COTTER PIN | 1 | 1 | 1 | |
| 12 | 09180-10044 | SPACER, propeller shaft bearing | 1 | 1 | 1 | 10x14x17 |

FIG. 11

B - 14

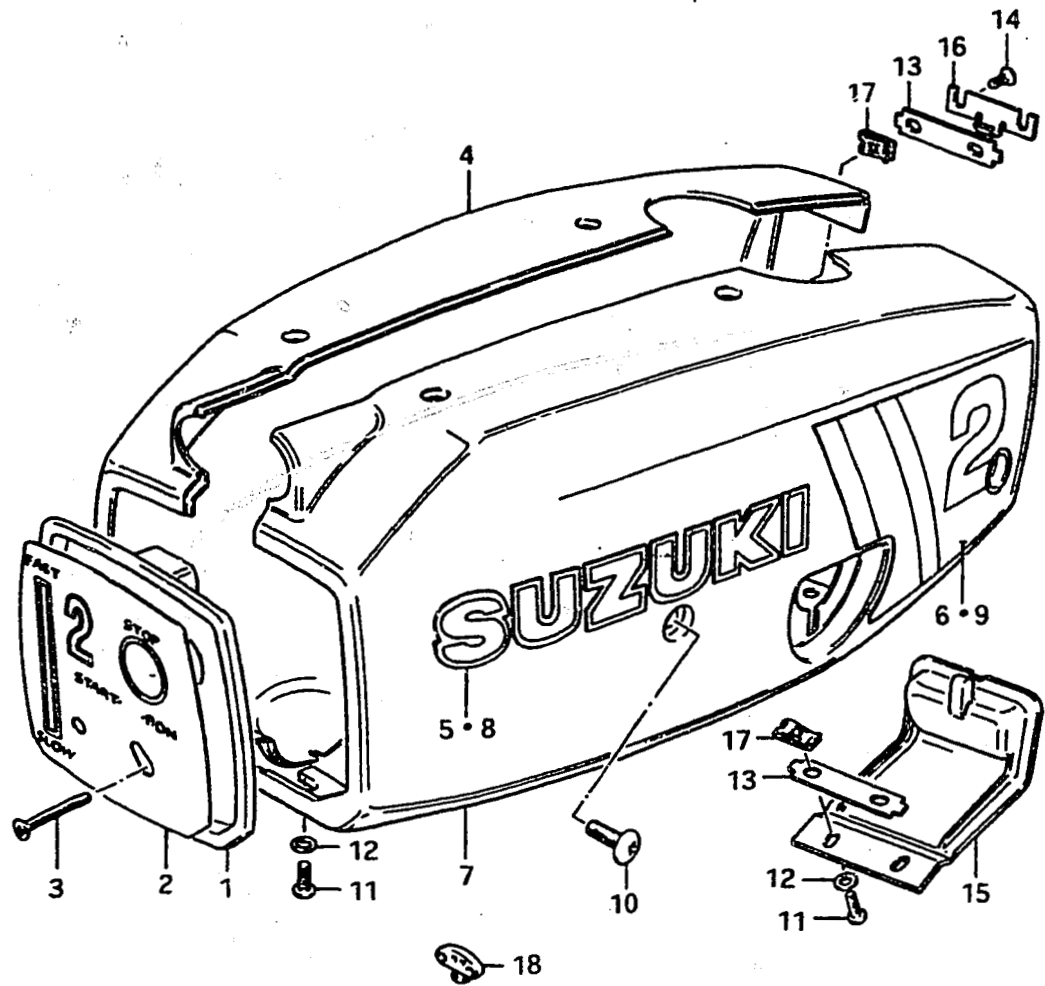

FIG. 11 ENGINE COVER

| Ref. No. | Part No. | Description | Q'ty | | | Remarks |
|----------|-----------------|----------------------------|------|---|---|--|
| | | | C | D | F | |
| 1 | 61420-98400 | EMBLEM, engine cover front | 1 | 1 | 1 | |
| 2 | 61422-98402 | MARK, front emblem | 1 | 1 | 1 | |
| 3 | 09126-04003 | SCREW (4x35) | 2 | 2 | 2 | |
| 4-1 | 61460-98812-01T | COVER SET, engine RH | 1 | 1 | 1 | to 61460-98840-01T |
| 4-2 | 61460-98841-01T | COVER SET, engine RH | - | - | 1 | from 61460-98840-01T |
| 5-1 | 61441-98401 | •EMBLEM, "SUZUKI" | 1 | 1 | - | |
| 5-2 | 61441-98410 | •EMBLEM, "SUZUKI" | - | - | 1 | from 61441-98401 |
| 6 | 61445-98410 | •STRIPE, side RH | 1 | 1 | 1 | from 61445-98400 |
| 7-1 | 61470-98813-01T | COVER SET, engine LH | 1 | 1 | 1 | from 61470-98810-01T |
| 7-2 | 61470-98831-01T | COVER SET, engine LH | - | - | 1 | from 61470-98813-01T from 61470-98830-01T |
| 8-1 | 61441-98401 | •EMBLEM, "SUZUKI" | 1 | 1 | - | |
| 8-2 | 61441-98410 | •EMBLEM, "SUZUKI" | - | - | 1 | |
| 9 | 61455-98410 | •STRIPE, side LH | 1 | 1 | 1 | from 61455-98400 |
| 10 | 09125-06025 | SCREW (6x20) | 4 | 4 | 4 | |
| 11-1 | 02112-05128 | SCREW | 4 | - | - | |
| 11-2 | 09125-05028 | SCREW (5x12) | - | 4 | 4 | |
| 12-1 | 08322-11058 | WASHER | 4 | - | - | |
| 12-2 | 09160-05010 | WASHER (5.5x10x0.8) | - | 4 | 4 | |
| 13-1 | 61465-98401 | PLATE, engine cover | 4 | 4 | 4 | to 61465-98402 |
| 13-2 | 61490-98400 | PLATE, engine cover | - | - | 4 | |
| 14 | 09126-05003 | SCREW (5x12) | 6 | 6 | 6 | |
| 15 | 61481-98401 | HINGE, engine cover | 1 | 1 | 1 | |
| 16 | 61485-98401 | SPRING, engine cover hinge | 1 | 1 | 1 | |
| 17-1 | 09148-05009 | NUT | 8 | 8 | 8 | to 09148-05011 |
| 17-2 | 09148-05011 | NUT | - | - | 4 | for 61490-98400 |
| 18 | 61521-98400 | HOLDER, shear pin | - | 1 | 1 | |

FIG.12

B - 15

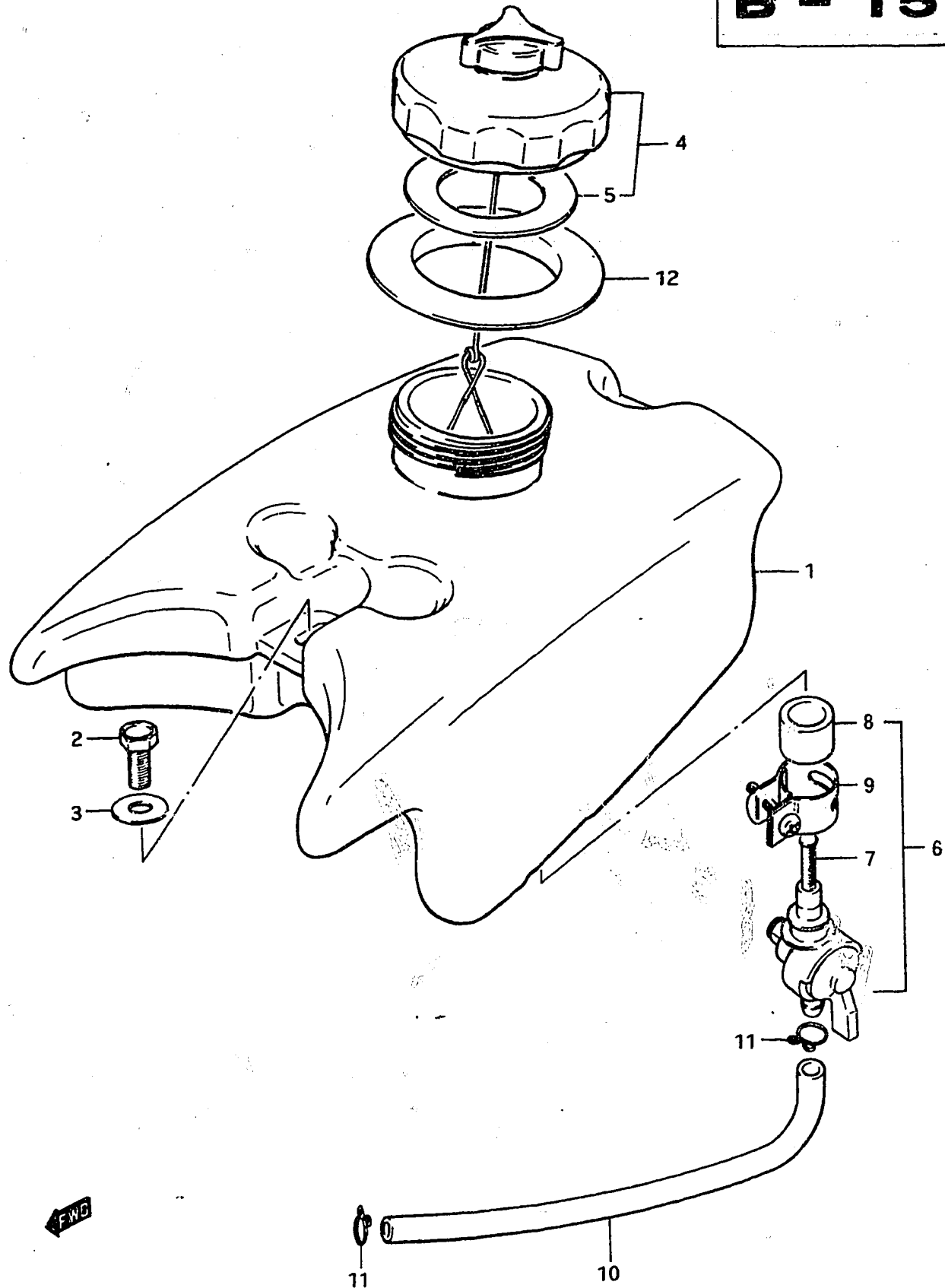

FIG.12 FUEL TANK

| Ref. No. | Part No. | Description | Q'ty | | | Remarks |
|----------|-------------|---------------------|------|---|---|------------------|
| | | | C | D | F | |
| 1-1 | 65111-98400 | TANK, fuel | 1 | 1 | - | to 65111-98401 |
| 1-2 | 65111-98401 | TANK, fuel | - | - | 1 | to 65111-98402 |
| 1-3 | 65111-98402 | TANK, fuel | - | - | 1 | to 65111-98403 |
| 2 | 01107-06168 | BOLT | 2 | 2 | 2 | |
| 3 | 09160-06016 | WASHER (6x16x1.2) | 2 | 2 | 2 | to 09160-06019 |
| 4-1 | 65510-98400 | CAP ASSY, fuel tank | 1 | - | - | to 65510-98401 |
| 4-2 | 65510-98401 | CAP ASSY, fuel tank | - | 1 | - | to 65510-98402 |
| 4-3 | 65510-98402 | CAP ASSY, fuel tank | - | - | 1 | |
| 5 | 09168-32001 | GASKET (32x48x2.5) | 1 | 1 | 1 | |
| 6 | 66100-98400 | COCK ASSY, fuel | 1 | 1 | 1 | to 66100-98401 |
| 7 | 66152-98400 | FILTER | 1 | 1 | 1 | |
| 8 | 66142-98401 | PIPE, joint | 1 | 1 | 1 | from 66142-98400 |
| 9 | 66165-98400 | CLAMP | 1 | 1 | 1 | to 66165-98401 |
| 10-1 | 09343-05031 | HOSE, fuel (L:220) | 1 | - | - | |
| 10-2 | 09343-05129 | HOSE, fuel (L:240) | - | 1 | 1 | |
| 11 | 09401-08401 | CLIP, fuel hose | 2 | 2 | 2 | to 09401-09402 |
| 12 | 65281-98400 | GROMMET, fuel tank | 1 | 1 | 1 | |

FWG

FIG.9

K - 11

FIG.9 OPT : GASKET / TOOL SET

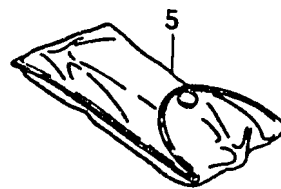
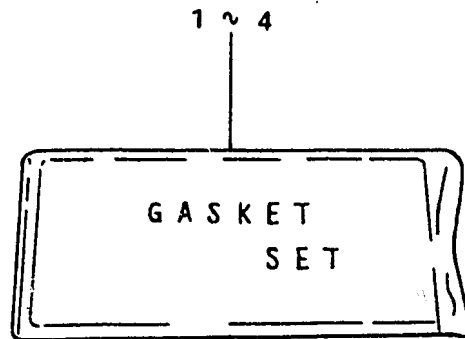

| Ref. No. | Part No. | Description | Q'ty | Remarks |
|----------|-------------|----------------------|------|--|
| 1 | 11400-98840 | GASKET SET (ENGINE) | 1 | DT3.5 |
| 2 | 11400-98820 | GASKET SET (ENGINE) | 1 | DT4,DT4.5 |
| 3-1 | 11400-98830 | GASKET SET (ENGINE) | 1 | DT5D, to 11400-98831 |
| 3-2 | 11400-98832 | GASKET SET (ENGINE) | 1 | DT5F to 11400-98833 to 11400-98834 |
| 3-3 | 11400-98833 | GASKET SET (ENGINE) | 1 | |
| 4 | 11400-96820 | GASKET SET (ENGINE) | 1 | DT7.5,DT9 to 11400-96821 |
| 5-1 | 09800-00128 | TOOL SET (DT3.5~DT9) | 1 | to 09800-00805 |
| 5-2 | 09800-00178 | TOOL SET (DT2) | 1 | to 09800-00805 |

FIG.10

K - 12

10

FIG.10 OPT : LIGHTING COIL, EMERGENCY SWITCH

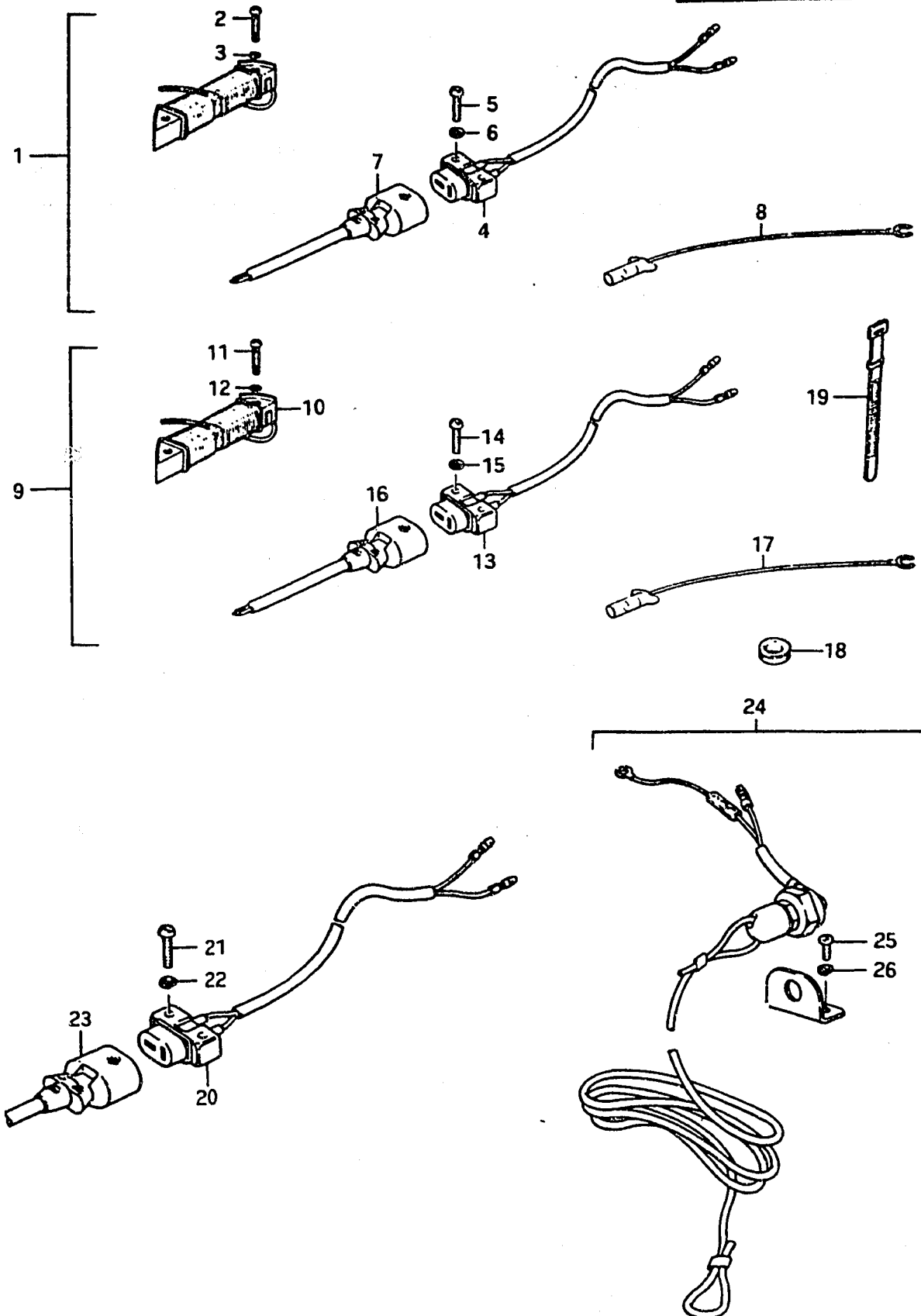

| Ref. No. | Part No. | Description | Q'ty | | Remarks |
|----------|-------------|---|------|--|---------------------------|
| | | | 2~9 | | |
| 1 | 32200-98821 | COIL SET, lighting to (32200-98300)+(39600-98300) | 1 | | DT2 DT3.5 DT4,DT4.5 |
| 2 | 02112-05258 | •SCREW | 2 | | |
| 3 | 08321-21058 | •LOCK WASHER | 2 | | |
| 4 | 39601-96711 | •SOCKET ASSY | 1 | | |
| 5 | 02112-04208 | •SCREW | 2 | | |
| 6 | 08322-21048 | •WASHER | 2 | | |
| 7 | 39602-99711 | •PLUG ASSY, lighting | 1 | | |
| 8 | 36898-93300 | •LEAD WIRE, earth | 1 | | |
| 9 | 32200-98832 | COIL SET, lighting | 1 | | DT5 DT7.5,DT9 |
| 10 | 32120-98520 | •COIL, lighting | 1 | | |
| 11 | 02112-06258 | •SCREW | 2 | | |
| 12 | 08321-21068 | •LOCK WASHER | 2 | | |
| 13 | 39601-96711 | •SOCKET ASSY | 1 | | |
| 14 | 02112-04258 | •SCREW | 2 | | |
| 15 | 08322-21048 | •WASHER | 2 | | |
| 16 | 39602-99711 | •PLUG, lighting | 1 | | |
| 17 | 36898-93300 | •LEAD WIRE, earth | 1 | | |
| 18 | 09308-10002 | •GROMMET, lead wire | 1 | | |
| 19 | 09407-12402 | •CLAMP, lead wire | 1 | | |
| 20 | 39601-96711 | •SOCKET ASSY | 1 | | DT2~DT9 |
| 21 | 02112-04208 | •SCREW | 2 | | |
| 22 | 08322-21048 | •WASHER | 2 | | |
| 23 | 39602-99711 | •PLUG, lighting | 1 | | |
| 24-1 | 37800-93812 | SWITCH SET, emergency from 37800-93811 | 1 | | DT2~DT9 |
| 24-2 | 37800-93813 | SWITCH SET, emergency from 37800-93812 | 1 | | |
| 25 | 09125-04011 | •SCREW | 2 | | |
| 26 | 09162-04002 | •LOCK WASHER | 2 | | |

FIG.14

L - 2

FIG.14 OPTIONAL

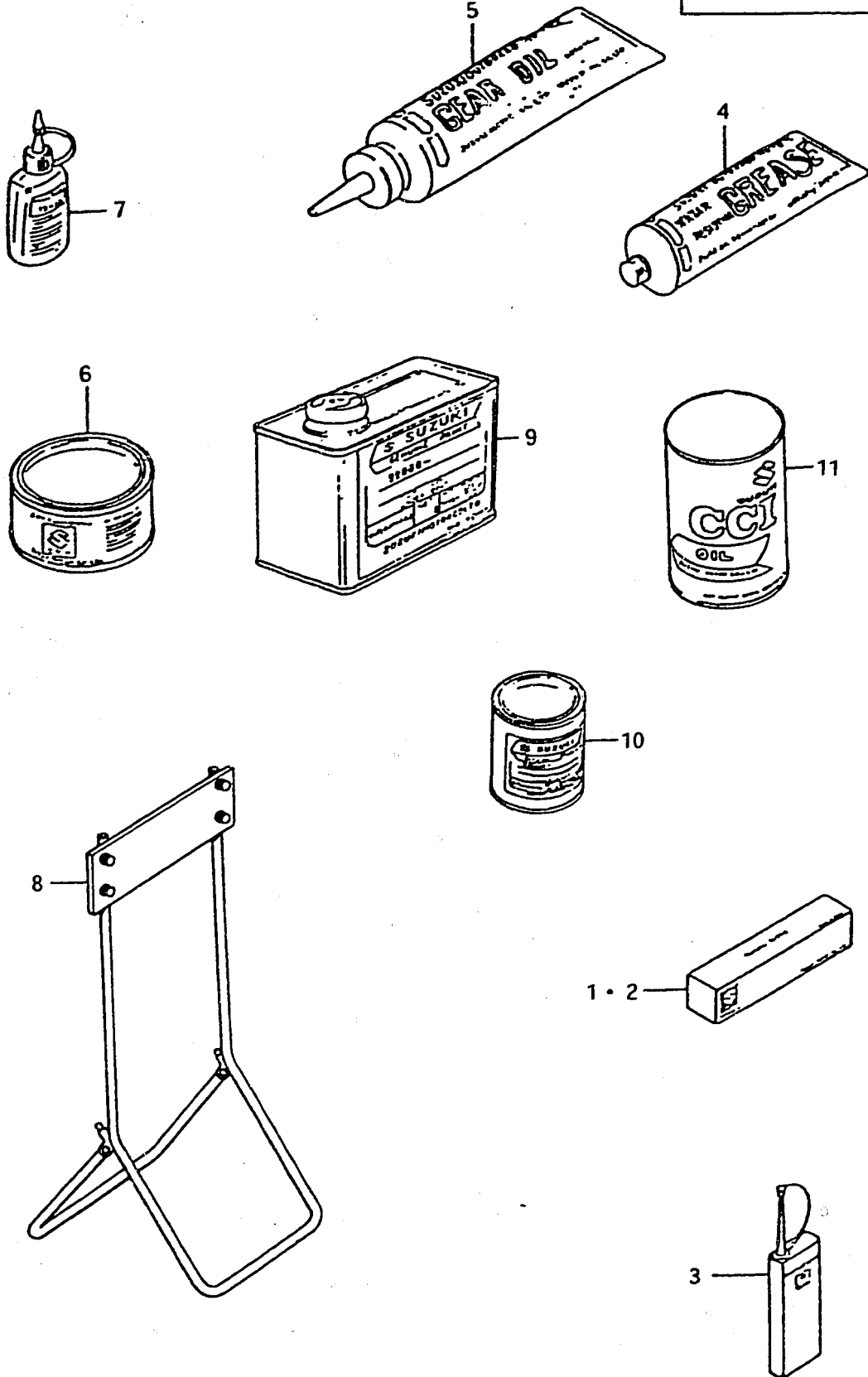

| Ref. No. | Part No. | Description | Q'ty | Remarks |
|----------|-----------------|----------------------------|------|-------------------------|
| 1 | 99000-31030 | GASKET, liquid | 1 | for crankcase,100g |
| 2 | 99000-31050 | GASKET, liquid | 1 | for gear case,100g |
| 3 | 99000-32040 | CEMENT, thread lock | 1 | 200g |
| 4-1 | 99000-25160 | GREASE, water resistant | 1 | 250g |
| 4-2 | 99000-25170 | GREASE, water resistant | 1 | 50g |
| 5 | 99000-22540 | GEAR OIL, outboard motor | 1 | 400cc |
| 6 | 99000-25010 | SUZUKI SUPER GREASE A | 1 | 450g,for crank oil seal |
| 7 | 99000-32030 | SUZUKI LOCK SUPER | 1 | 50g (1303B) |
| 8 | 09914-39911 | HANGER, engine | 1 | |
| 9-1 | 99000-10105-01T | PAINT (500g) | 1 | |
| 9-2 | 99000-10205-01J | PAINT (500g) | 1 | |
| 10-1 | 99000-10109-01T | PAINT (90g) | 1 | |
| 10-2 | 99000-10209-01J | PAINT (90g) | 1 | |
| 11-1 | 99000-21460 | CCI OIL (1ℓx24,Mitsubishi) | 1 | |
| 11-2 | 99000-21145 | CCI OIL (1ℓx24,Shell) | 1 | |
| 11-3 | 99000-21021 | CCI OIL (4ℓx6) | 1 | |
| 11-4 | 99000-21150 | CCI OIL (200ℓ) | 1 | |
| 11-5 | 99000-21250 | CCI SUPER OIL (1ℓx24) | 1 | |
| 11-6 | 99000-21260 | CCI SUPER OIL (4ℓx6) | 1 | |